

You have the option to either retain your existing OEM connector or choose to rewire your vehicles harness to use the Revotec fan connector (RTB-2). This kit provides both types of connection.

Before commencing any re-wiring, test and note the polarity of the original fan and wiring harness. The supplied fan should operate as a suction fan. Test fully before starting the vehicle engine.

FAN CONVERSION TO MALE MAZDA LOOM

STEP 1A

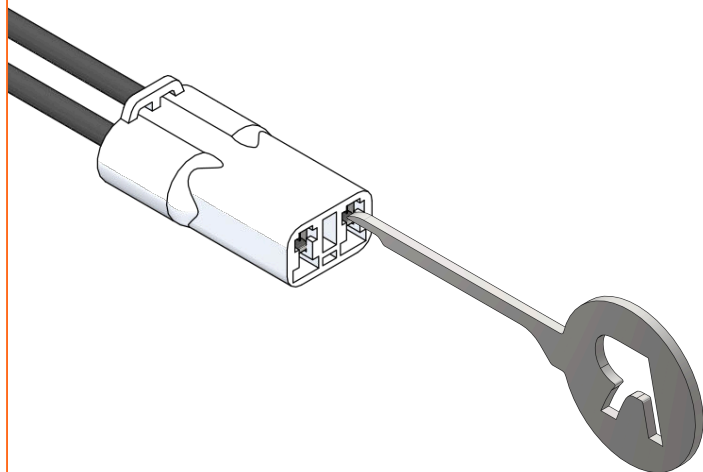

STEP 1B

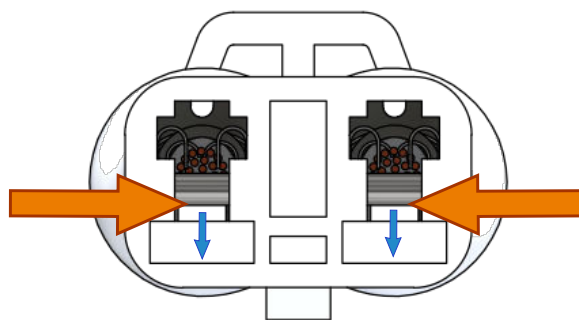

STEP 1C

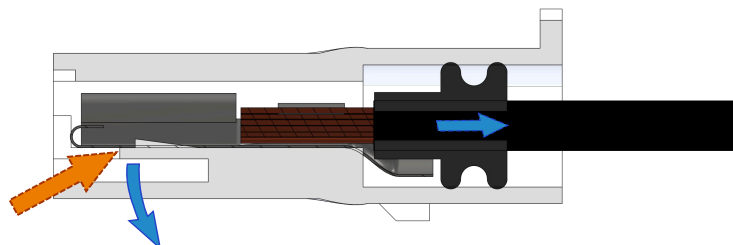

Remove the fan to be replaced from the vehicle and place on a workbench; A well-lit area is advised. NOTE CABLE POSITIONS / POLARITY AT THIS STAGE (+ and -). Insert the supplied pin removal tool between the female terminal and the retaining lug. Use slight force to lever the retaining lugs as shown above. The cables may need to be pushed inwards to relieve pressure on the lugs to allow removal. Step 1A and 1B show the lugs from the front and as a section view through.

STEP 2

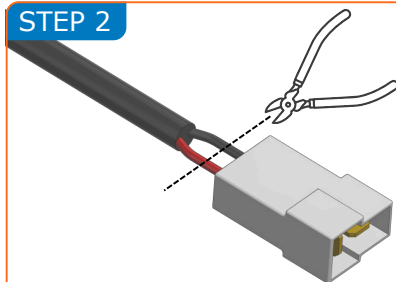

Using wire cutters, remove the white plug from the supplied fan.

STEP 3

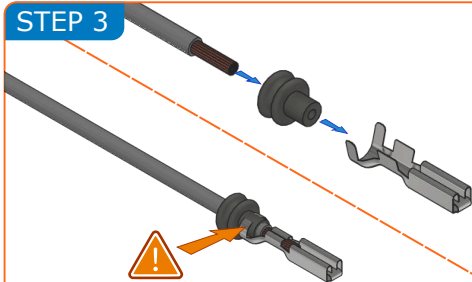

Slide the cables through the supplied rubber seals before removing 1/4" (6mm) of shroud to reveal the wire core. Crimp the male spade connectors, noting the rubber seal position, as shown.

STEP 4

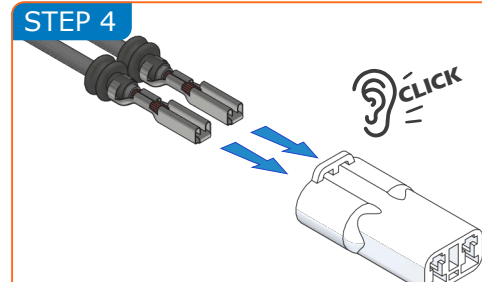

Noting the polarity, insert the crimped spade terminals into male connector (removed in step 1) as shown. Ensure the cables are fully located - retaining catches will click into place.

FAN CONVERSION TO FEMALE MAZDA LOOM

STEP 1A

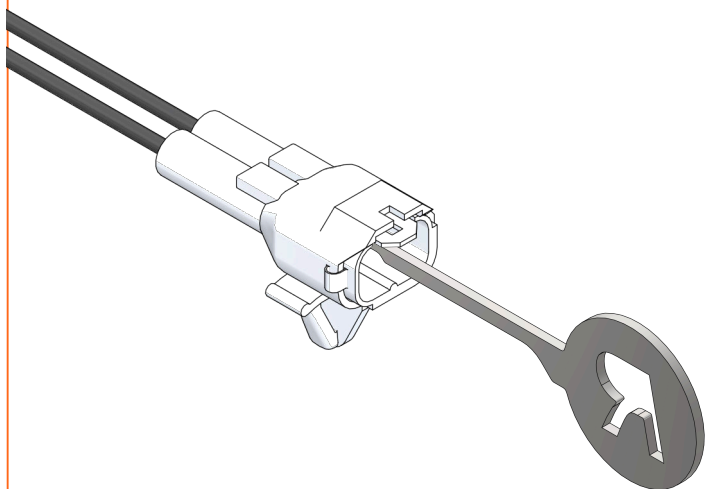

STEP 1B

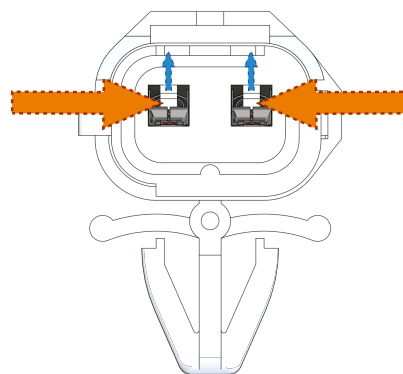

STEP 1C

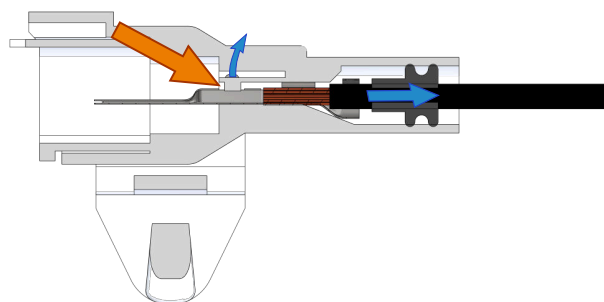

Remove the fan to be replaced from the vehicle and place on a workbench; A well-lit area is advised. NOTE CABLE POSITIONS / POLARITY AT THIS STAGE (+ and -). Insert the supplied pin removal tool between the male spade and the retaining lug. Use slight force to lever the retaining lugs as shown above. The cables may need to be pushed inwards to relieve pressure on the lugs to allow removal. Step 1A and 1B show the lugs from the front and as a section view through.

STEP 2

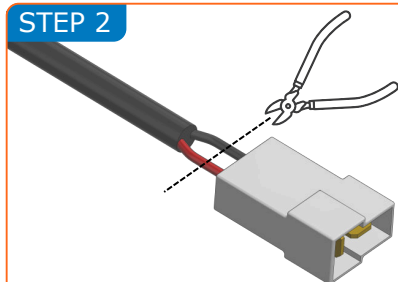

Using wire cutters, remove the white plug from the supplied fan.

STEP 3

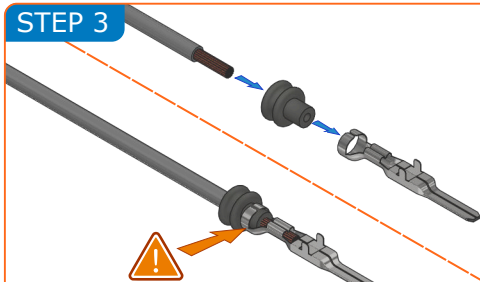

Slide the cables through the supplied rubber seals before removing 1/4" (6mm) of shroud to reveal the wire core. Crimp the male spade connectors, noting the rubber seal position, as shown.

STEP 4

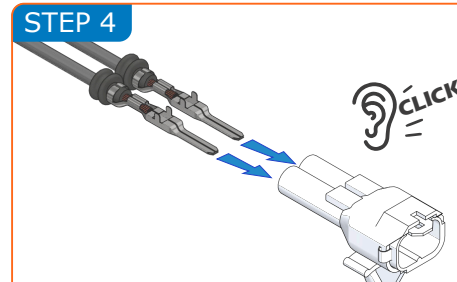

Noting the polarity, insert the crimped spade terminals into female connector (removed in step 1) as shown. Ensure the cables are fully located - retaining catches will click into place.

LOOM CONVERSION TO REVOTEC FAN

STEP 1

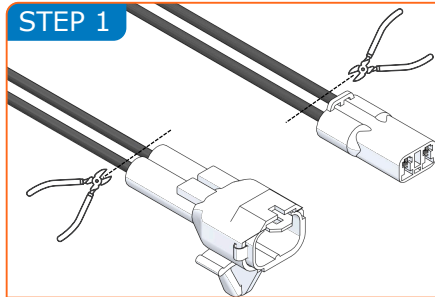

Using wire cutters, remove the white plug from the vehicle wiring loom.

STEP 2

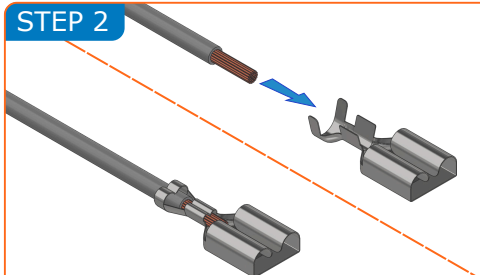

Remove 1/4" (6mm) of cable shroud to reveal the wire core. Crimp the female spade connectors as shown.

STEP 3

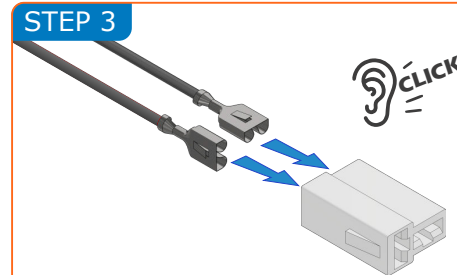

Noting the polarity, insert the crimped spade terminals into the supplied RTB-2 connector as shown. Ensure the cables are fully located - retaining catches will click into place.

IMPORTANT NOTES

Installations are to be undertaken by a competent vehicle mechanic.
If in doubt, consult a qualified professional.
Always work in a safe environment and wear PPE where necessary.
Disconnect the vehicle battery before beginning installation.
Failure to comply with the above may result in your warranty being void.